

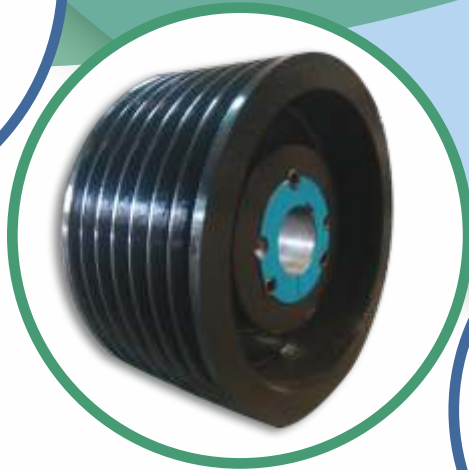



SUPER MECH INDUSTRIES



**MANUFACTURER AND STOCKIEST OF
ALL TYPES OF GEAR COUPLES, V BELT PULLEYS,
SPROCKETS, ROLLING, SUGAR, CONSTRUCTION
MACHINERY & CEMENT PLANT MACHINERY
SPARES**

 www.smigearcoupling.com
www.gearcouplingindia.com
www.gearcoupling.net





Gear Couplings

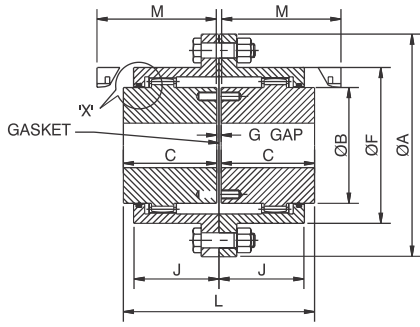

FULL GEAR COUPLE

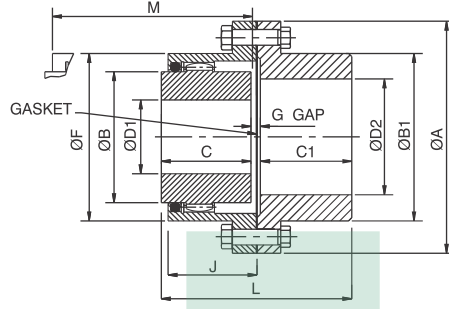

HALF GEAR COUPLE

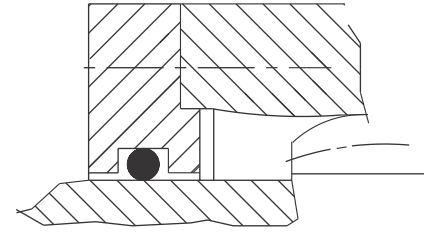

DETAIL 'X'
THIS COVER PLATE
CONSTRUCTION FOR
SIZES FG - 111 ONWARDS

Size	KW at 100 rpm	Rated Torque nm	Max. rpm	Bore			ØA	C	C1	ØB	ØB1	ØF	M	G	J	L	Solid Hub	
				PB	D1	D2											WT. kg-m ²	M.I. (WR ²) kg-m ²
FG-100	5.9	559	7600	13	35	45	120	45	45	50	65	75	54	3	39	93	5	0.01
FG-101	11.8	1127	6300	21	50	60	170	55	55	65	85	110	67	5	49	115	11	0.04
FG-102	29.4	2804	5000	30	60	75	185	70	70	85	110	125	83	5	62	145	15	0.05
FG-103	52.9	5047	4000	40	75	90	220	85	85	105	130	150	103	5	78	175	26	0.12
FG-104	100	9557	3350	50	90	110	250	105	105	130	160	175	124	5	96	215	40	0.24
FG-105	153	14605	2800	60	110	130	290	110	110	155	185	200	136	10	106	230	63	0.49
FG-106	235	22444	2500	75	125	150	320	125	125	175	215	230	152	10	117	260	85	0.75
FG-107	412	39303	2100	90	140	170	350	140	140	205	240	260	174	10	134	290	110	1.31
FG-108	529	50472	1900	105	160	200	380	155	155	230	285	290	187	10	147	320	160	2.13
FG-109	658	62821	1700	125	180	220	430	165	165	250	315	330	196	10	156	340	210	3.75
FG-110	963	91923	1400	140	220	260	490	180	180	310	370	390	216	10	171	370	277	7.63
FG-111	1289	123065	1250	160	260		545	200		350		445	245	10	191	410	550	14.5
FG-112	1723	164516	1120	180	300		590	240		400		490	289	10	230	490	710	22
FG-113	2344	223793	1000	200	330		680	260		440		555	312	15	241	535	980	34.5
FG-114	3351	320012	900	220	370		730	280		500		610	341	15	265	575	1320	72.75
FG-115	4071	388738	800	250	410		780	320		540		660	385	15	303	655	1700	88.25
FG-116	7028	671165	710	300	455		900	350		625		755	423	20	333	720	2550	172
FG-117	9997	954665	630	375	520		1000	400		720		855	489	20	384	820	3620	309
FG-118	13236	1263938	560	450	610		1100	450		810		950	533	20	428	920	4860	491
FG-119	174554	1666744	500	520	710		1250	485		910		1050	559	30	444	1000	6380	753





Naylone Gear Couplings

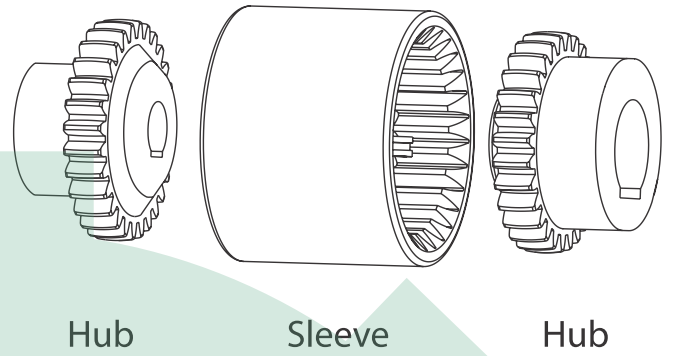
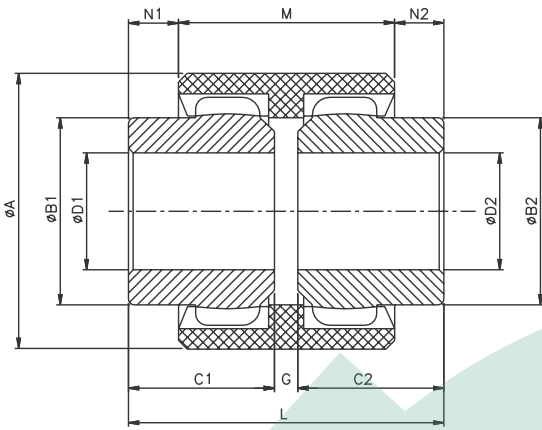

Coupling size	Rating at 100 rpm		Rated Torque (N-m)	Max. Speed rpm	Max. Bore (OD1, OD2) mm	ØA	ØB1 ØB2	C1 C2	G	M	N1 N2	Wt. in Kg.	M.I. (WR*) in Kgm ²	Maximum Misalignment		
	KW	HP												Axial ± mm	Radial ± mm	Angular ± mm
M-19	0.17	0.22	16	11800	20	48	32	25	4	37	8.5	0.23	0.47	1	0.3	± 1°
M-24	0.21	0.28	20	10600	24	52	36	26	4	41	7.5	0.32	0.93	1	0.4	± 1°
M-28	0.47	0.63	45	8500	28	66	44	40	4	46	19	0.74	3.09	1	0.4	± 1°
M-38	0.84	1.12	80	6700	38	83	58	40	4	48	18	1.23	8.68	1	0.4	± 1°
M-42	1.00	1.34	100	6000	42	92	65	42	4	50	19	1.5	14.28	1	0.4	± 1°
M-48	1.50	2.10	140	5600	48	95	68	50	4	50	27	1.81	18.34	1	0.4	± 1°
M-65	4.00	5.36	380	4000	65	132	96	55	4	68	23	4.35	84.80	1	0.4	± 1°





Brake Drum Geared Coupling

Coupling Size	Torque	Max RPM	Finish Bore		Ø A	Ø B	C	Ø D	E	L	L1	L2	Weight (KG.)
			Min	Max									
SBDGC4"	980	8000	15	40	101.6	80	70	65	15	102.5	43	57	5.0
SBDGC5.5"	1600	6300	15	45	139.7	85	85	70	20	125	55	67	12.6
SBDGC6"	2450	6300	15	45	152.5	90	85	70	20	125	55	67	14.0
SBDGC6.3"	2450	6300	15	45	160.0	90	85	70	20	125	55	67	16.0
SBDGC7"	4400	5000	20	55	177.8	120	95	85	20	140	60	75	20.0
SBDGC8"	8350	4000	20	75	203.2	120	95	120	20	145	58	82	26.8
SBDGC10"	19620	3350	25	90	254.0	150	115	140	20	170	73	92	50.0
SBDGC12"	31500	2850	25	110	304.8	225	125	175	30	204	75	124	68.0

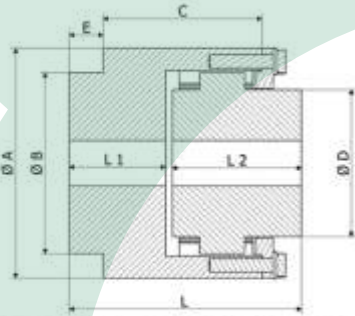

BRAKE DRUM GEARED COUPLING

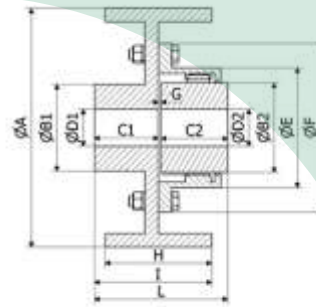

BRAKE DRUM WITH GEAR COUPLING

Brake Drum With Gear Coupling

Size	Finish Bore			Torque (NM)	Max. RPM	Ø A	Ø B1	Ø B2	C1	C2	Ø E	Ø F	G	H	I	L	Weight (KG)
	Min	D1 Max	D2 Max														
SBDC 150	15	40	32	500	7900	150	65	50	64	45	75	120	1	80	95	110	7.600
SBDC 160	15	45	32	500	7900	160	70	50	74	45	75	120	1	90	110	120	9.000
SBDC 178	15	45	32	700	8100	178	70	50	74	45	75	120	1	90	110	120	10.500
SBDC 200	20	55	40	1000	6400	200	90	65	77	55	110	170	2	100	120	134	15.500
SBDC 250	20	65	40	1000	6400	250	105	65	77	55	110	170	2	120	130	134	24.500
SBDC 250A	20	65	55	2710	5000	250	105	85	77	70	125	185	2	120	130	149	27.000
SBDC 300	30	85	68	4900	4000	300	130	105	105	85	150	220	2	150	170	192	50.000
SBDC 300A	40	85	85	9200	3350	300	130	130	105	105	175	250	2	150	170	212	57.000
SBDC 375	40	85	85	9200	3350	375	135	130	110	105	175	250	3	165	185	218	84.000
SBDC 400	40	95	85	9200	3350	400	150	130	118	105	175	250	3	180	210	226	91.000
SBDC 400A	40	95	100	14300	2800	400	150	155	116	110	200	290	4	180	210	230	100.000
SBDC 450	40	110	100	14300	2800	450	170	155	120	110	200	290	5	200	220	235	123.000
SBDC 450A	40	110	110	21950	2500	450	170	175	120	125	230	320	5	200	220	250	132.000
SBDC 500	50	135	110	21950	2500	500	210	175	145	125	230	320	5	225	250	275	189.000



☎ +91 98794 30132

☎ +91 96621 60816



Brake Drum Pin Bush Coupling

Size	Max RPM	Torque	Bore		No. of PIN	Ø A	Ø B	C	Ø D	E	L	G	Approx Weight KG
			Min	Max									
SPBDC-150	3800	515	10	40	6	150	60	50	130	85	102	2	7.000
SPBDC-160	3200	750	10	40	6	160	60	50	130	85	102	2	8.500
SPBDC-178	3400	850	10	40	6	178	60	50	130	85	102	2	9.300
SPBDC-200	2800	1050	15	60	6	200	90	60	176	105	123	3	17.000
SPBDC-250	2400	1660	20	70	6	250	105	76	225	110	155	3	32.000
SPBDC-300	2000	5060	30	105	10	300	160	90	276	140	183	3	48.000
SPBDC-380	1500	7260	40	130	18	380	200	130	336	175	283	3	122.000
SPBDC-400	1450	7300	40	130	18	400	200	130	342	175	283	3	128.000
SPBDC-500	1200	9930	50	145	13	500	225	160	430	210	326	6	255.000
SPBDC-600	1000	14100	50	165	16	600	255	180	500	235	366	6	395.000
SPBDC-750	800	23700	50	185	20	750	285	200	630	275	406	6	630.000

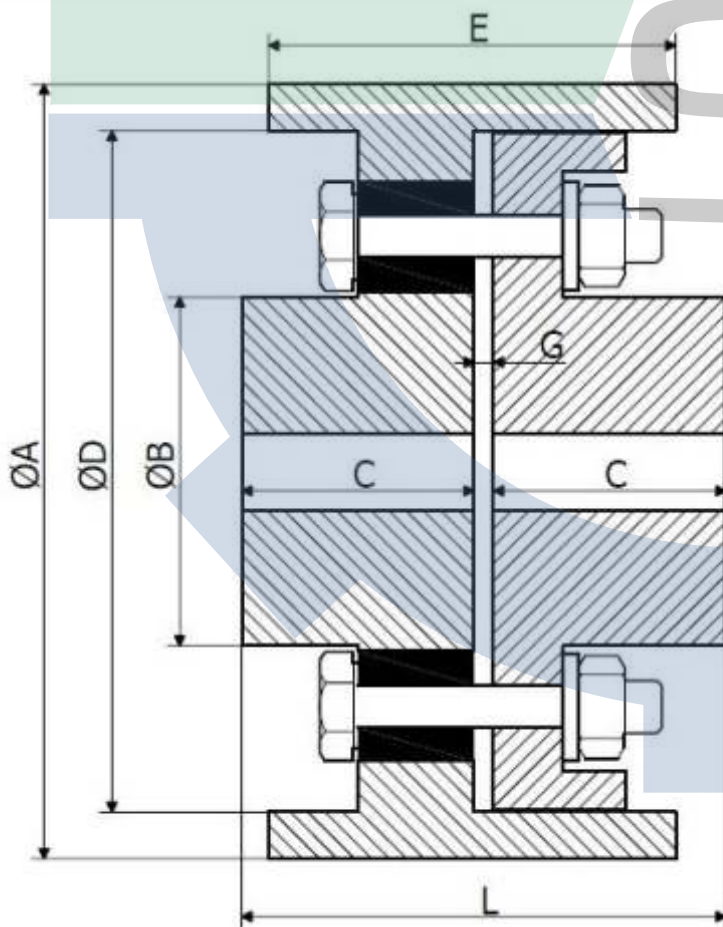



Star Couplings

Coupling Size	Torque (NM)	KW at 100 RPM	Finish Bore		Ø A	Ø B	L	Weight Approx
			Min	Max				
SJC 75	9.8	0.10	10	20	44.5	39	55	0.5
SJC 90	15.5	0.15	15	28	54	49	56	0.7
SJC 95	21.1	0.22	15	28	54	49	63	0.8
SJC 99	35.1	0.37	20	35	65	57	72	.1.5
SJC 100	46.4	0.49	20	35	65	57	88	1.5
SJC 110	89	0.93	20	45	85	76	108	3.0
SJC 150	141	1.49	30	48	96	80	115	3.7
SJC 190	190	2.01	36	60	115	102	133	6.8
SJC 225	265	2.75	40	65	127	111	153	9.1
SJC 226	327	3.45	25	70	137	119	178	12.0
SJC 276	532	5.60	25	75	157	127	200	18.0
SJC 280	782	8.20	30	85	192	140	200	24.0
SJC 295	1279	13.40	40	100	237	162	238	44.0

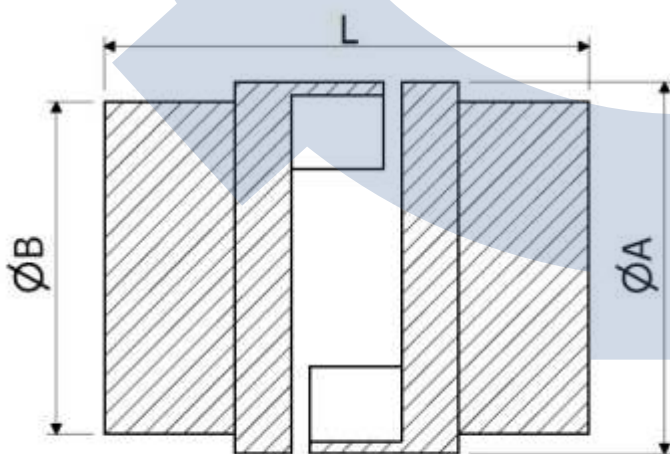



HRC Coupling

Coupling Size	Power @ 100 RPM KW	Torque nm	Finish Bore		Ø A	Ø B	C	D	Ø E	F	G	L	Approx Weight Kg.
			Min.	Max.									
SHRC 70	0.33	31	10	38	69	60	20	24	31	26.0	18.0	66.0	1.000
SHRC 90	0.84	80	10	45	85	70	26	30	32	30.5	22.5	82.5	1.700
SHRC 110	1.68	160	10	65	112	100	37	45	45	45.0	29.0	119.0	5.000
SHRC 130	3.30	315	14	65	130	105	47	56	50	54.0	36.0	148.0	5.600
SHRC 150	6.28	600	19	75	150	115	50	60	62	60.0	40.0	160.0	7.300
SHRC 180	9.95	950	35	80	180	125	58	70	77	73.0	49.0	189.0	16.500
SHRC 230	20.90	2000	38	100	225	155	77	90	99	85.5	59.5	239.5	26.000
SHRC 280	33.00	3150	48	130	275	206	90	105	119	104.5	74.5	284.5	50.000

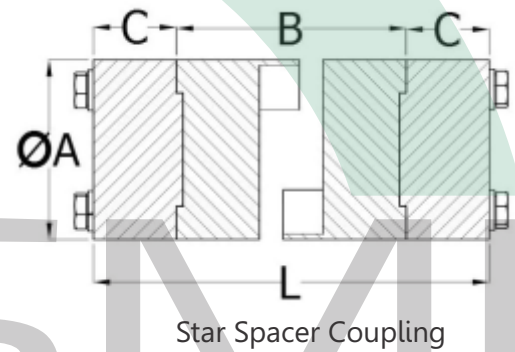
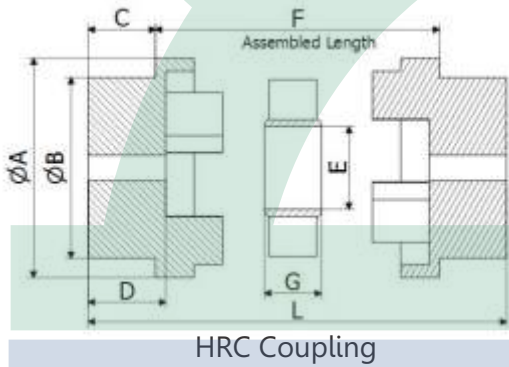

Star spacer coupling (RRL)

SIZE	BORE		Ø A	B	C	L	APPROX. WEIGHT IN KG						
SFSC 95	15	28	54	90	100	25	140	150	2.0	2.5			
SFSC 100	15	35	65	90	100	140	30	150	160	200	3.0	3.5	4.3
SFSC 110	20	42	85	90	100	140	35	160	170	210	5.8	6.3	8.0
SFSC 150	20	48	96	90	100	140	45	180	190	230	8.5	9.0	11.0
SFSC 190	30	55	115	90	100	140	51	192	202	242	12.5	13.5	16.0
SFSC 225	40	60	127	90	100	140	57	204	214	254	16.5	17.5	21.0
SFSC 226	40	65	130	100	140	180	60	220	260	300	23.2	27.5	32.0
SFSC 276	40	75	157	100	140	180	60	220	260	300	34	40.3	46.4
SFSC 280	40	85	190	100	140	180	65	230	270	310	52	61.2	70.3
SFSC 295	40	100	231	100	140	180	65	230	270	310	77.3	91	104.2





Chain Couplings

SIZE		TORQUE	PITCH	BORE		Ø A	Ø B	D	E	G	L	COVER		WEIGHT APPROX
				MIN	MAX							OD	H	
3812	6112	99	9.252 (3/8")	8	16	45	25	24.0	30	4.9	64.9	59	61	0.4
4012	8312	217	12.70 (1/2")	9	22	61	35	33.1	36	7.4	79.4	75	75	1.1
4014	8314	295	12.70 (1/2")	9	28	69	43	33.1	36	7.4	79.4	84	75	1.4
4016	8316	385	12.70 (1/2")	13	32	77	50	33.1	40	7.4	87.4	92	75	2
5014	1014	560	15.875 (5/8")	13	35	86	53	41.0	45	9.7	99.7	101	85	2.7
5016	1016	735	15.875 (5/8")	13	40	96	60	41.0	45	9.7	99.7	111	85	3.3
5018	1018	930	15.875 (5/8")	13	45	107	70	41.0	45	9.7	99.7	122	85	4.2
6018	1218	1750	19.05 (3/4")	18	56	128	85	51.1	56	11.5	123.5	142	106	7.4
6022	1222	2370	19.50 (3/4")	18	71	152	110	51.1	56	11.5	123.5	167	106	11.3
8018	1618	3880	25.40 (1")	23	75	170	115	65.3	63	15.2	141.2	186	130	16
8022	1622	5580	25.40 (1")	28	90	203	140	65.3	71	15.2	157.2	220	130	25.5
10020	2020	8780	31.75 (1.25")	33	110	233	160	81.9	80	18.8	178.8	250	148	38.5
12018	2418	13200	38.10 (1.5")	43	115	256	170	102.7	90	22.7	202.7	307	181	47.3
12022	2422	17100	38.10 (1.5")	53	145	304	210	102.7	100	22.7	222.7	357	181	72.8
16018	3218	28600	50.80 (2")	58	155	341	224	131.7	112	30	254	406	250	110
16022	3222	41700	50.80 (2")	73	190	405	280	131.7	140	30	310	472	250	184
20018	4018	57000	63.50 (2.5")	85	205	426	294	160.6	241	37.5	519.5	496	280	317
20022	4022	71900	63.50 (2.5")	95	260	507	374	160.6	241	37.5	519.5	578	280	488
24022	-	129000	76.20 (3")	117	290	608	420	197.3	353	45	751	-	-	872
24026	-	157000	76.20 (3")	147	365	705	520	197.3	353	45	751	-	-	1277
32022	-	255000	101.60 (4")	197	400	806	570	263.0	400	60	860	-	-	1791
40020	-	494000	127 (5")	247	450	932	640	332.3	512	75.6	1100	-	-	2862
40024	-	602000	127 (5")	297	560	1093	800	332.3	512	75.6	1100	-	-	4295
40028	-	717000	127 (5")	347	670	1255	960	332.3	512	75.6	1100	-	-	6020

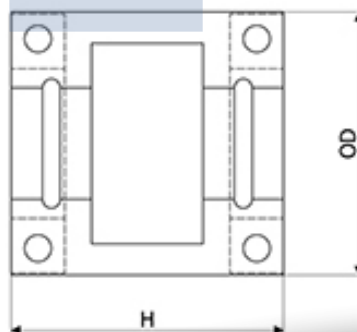
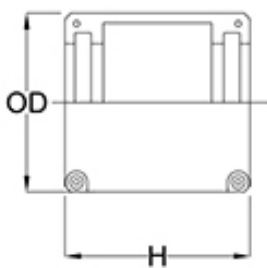
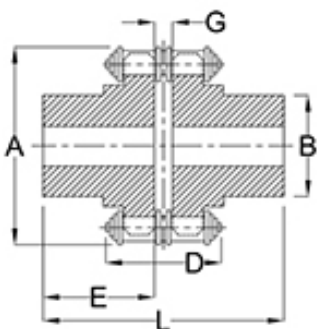

☎ +91 98794 30132

☎ +91 96621 60816



BC Type Couplings

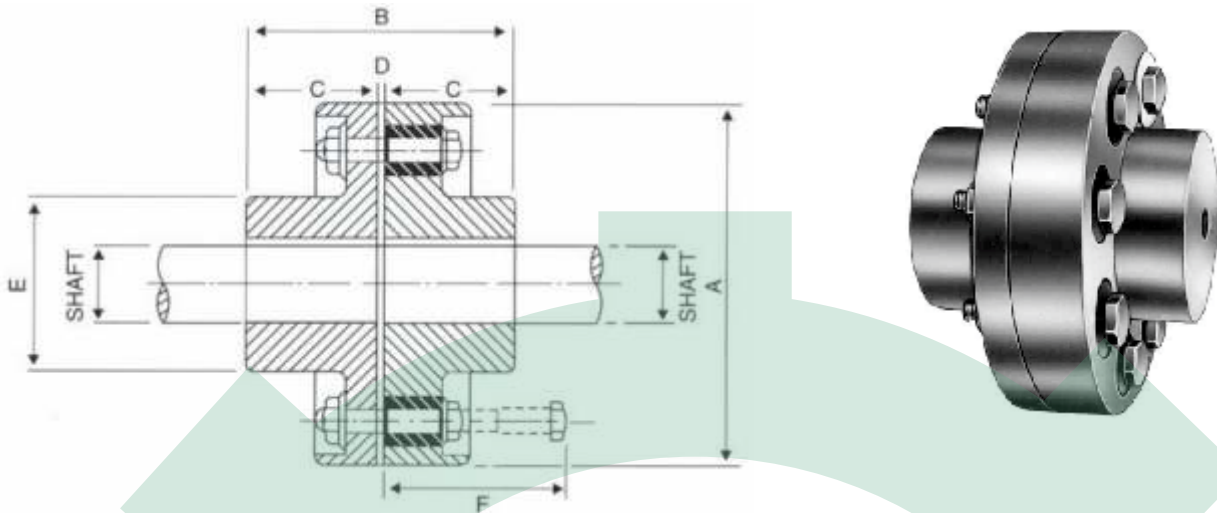

Size	No. of Pins	Torque Nm	Bore mm	Max. Bore mm	Max Speed Rev/min	A	B	C	D	E	F
BC-1	3	77	12.7	28	6100	95	79	38	3	40	58
BC-2	4	310	12.7	30	5100	114	99	48	3	42	70
BC-2A	6	516	16	42	4400	130	105	51	3	60	70
BC-3	4	621	16	48	3600	160	107	51	5	68	114
BC-4	4	831	20	65	3000	191	125	60	5	90	114
BC-4A	6	1241									
BC-5	6	1662	25	75	2600	225	157	76	5	105	114
BC-6	8	2359									
BC-6A	10	2932	45	90	2300	254	183	89	5	135	114
BC-6B	12	3533									
NBC-7	12	4154	60	115	1950	290	235	115	5	170	114
NBC-7A	14	5195	60	120	1900	300	235	115	5	180	130
NBC-8	16	5816	65	130	185	310	225	125	5	195	130
NBC-8A	15	7268	65	135	1650	340	265	130	5	200	130
NBC-8B	12	8729	70	140	1590	360	276	135	6	210	200
NBC-9	13	9932	80	150	1470	390	316	155	6	225	200
NBC-9A	15	13274	90	160	1400	410	336	165	6	240	200
NBC-10	16	14420	100	170	1300	440	366	180	6	255	200
NBC-10A	17	18050	110	180	1200	480	386	190	6	270	212
NBC11	20	23780	120	190	1080	530	406	200	6	285	212





RB Type Couplings

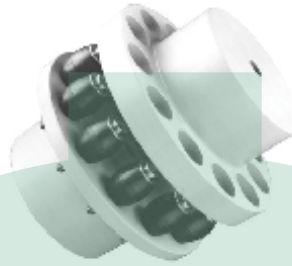
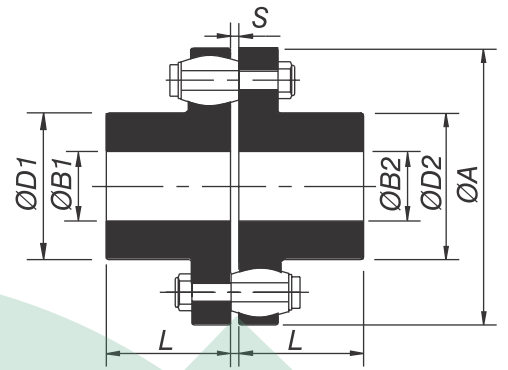
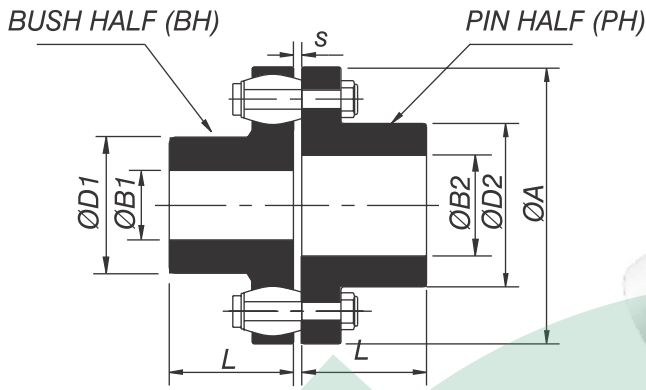

UPTO SIZE RB-630

FROM SIZE RB-400 ONWARDS

Coupling Size	KW 100 rpm	Torque mm	Max. Speed rpm	Min Bore	Max. Bore		U	OD1	Bd2	L	S	Wt. in KO.	M.I. (WR) kgm	Max Misalignment ±		
					Ob1	Bb2								Axial (mm)	radial (mm)	Angular
RB-105-3	1.0	95	7200	11	30	32	105	48	50	45	2-6	2	0.0030	2	0.3	1"
RB-116-4	1.5	146	6100	12	39	42	116	60	68	45	2-6	2.6	0.0050	2	0.3	1"
RB-124-4	1.7	166	5500	14	45	50	125	68	78	50	2-6	3.1	0.0070	2	0.4	1"
RB-144-6	3.3	318	4900	18	50	60	144	82	91	55	2-6	4.3	0.012	2	0.4	1"
RB-162-6	5.5	525	4500	22	60	65	162	89	100	60	2-6	7.5	0.030	2	0.4	1"
RB-178-6	6.7	643	3800	24	70	75	178	105	115	70	2-6	10	0.040	2	0.5	1"
RB-198-10	13	1248	3400	28	80	90	198	124	135	80	2-6	13	0.040	2	0.5	1"
RB-228-11	21	2050	3000	28	90	100	228	133	146	90	4-10	18	0.100	3	0.6	1"
RB-252-12	32	3069	2700	38	105	115	252	156	167	100	4-10	24	0.17	3	0.6	1"
RB-285-11	48	4552	2400	48	115	125	285	170	186	110	4-10	35	0.31	3	0.6	1"
RB-320-12	64	6099	2100	55	125	135	320	196	212	125	4-10	51	0.53	3	0.7	1"
RB-360-11	93	8900	1900	65	135	150	360	212	232	140	4-12	73	1.02	4	0.9	1"
RB-400-10	126	12051	1700	75	160	160	410	230	230	160	4-12	101	1.70	4	1.1	1"
RB-450-12	195	18602	1500	85	180	180	450	260	260	180	4-12	137	2.90	4	1.1	0.5"
RB-500-14	270	25802	1350	95	200	200	500	290	290	200	4-12	180	4.70	4	1.1	0.4"
RB-560-10	325	31003	1200	95	225	225	560	320	320	220	4-8	278	10.70	2	1.5	0.3"
RB-630-12	440	41998	1050	100	250	250	63	355	355	240	4-8	365	17.4	2	1.5	0.3"
RB-710-12	785	75000	950	100	260	260	710	385	385	260	5-9	516	33	2	1.8	0.3"
RB-800-14	1047	100000	850	100	280	280	800	420	420	29	5-9	691	53	2	1.8	0.3"
RB-900-16	1623	154998	750	100	305	305	900	465	465	320	5-9	927	86	2	1.8	0.3"
RB-1000-18	2042	194997	680	125	320	320	1000	515	515	350	5-70	1224	142.8	2	2	0.1"
RB-1120-18	2827	269997	600	135	350	350	1120	560	560	380	6-11	1584	231	2	2.2	0.1"
RB-1250-20	3613	344997	550	150	380	380	1250	610	610	420	6-11	2070	367.5	2	2.4	0.1"
RB-1400-20	5550	529999	490	175	440	440	1400	700	700	480	6-12	3060	693	2	2.7	0.1"
RB-1600-24	7854	749995	430	200	480	480	1600	770	770	540	6-12	3960	1155	2	3	0.1"
RB-1800-22	10210	974996	380	225	540	540	1800	870	870	600	8-16	5760	2205	2	3.4	0.1"
RB-2000-26	13614	1299997	340	250	600	600	2000	960	960	660	8-16	7020	3255	2	3.8	0.1"



Tyre Couplings - A Series

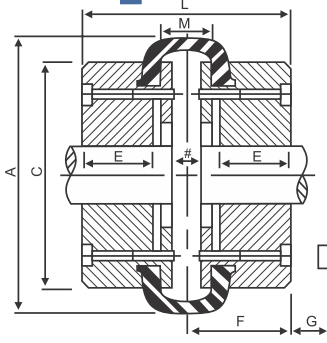

A-40 & 45

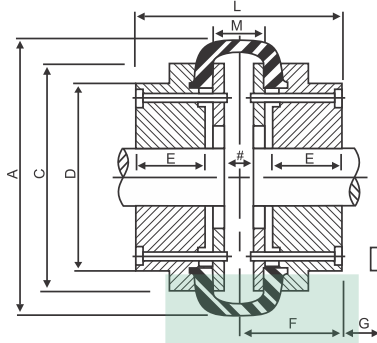

A-50

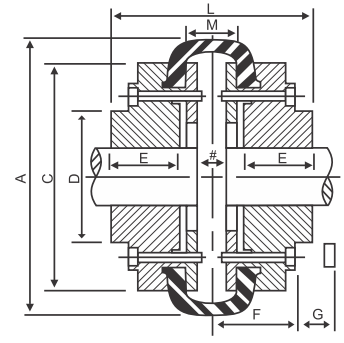

A-60

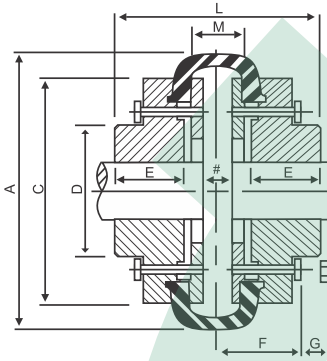

A-70 & 120

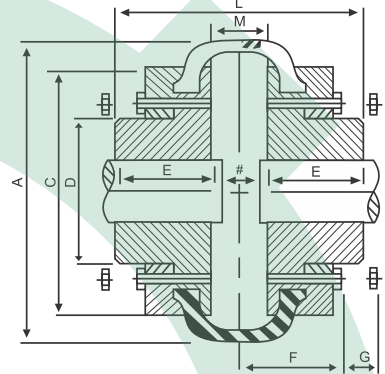

A-140 & 250

Size	Type A										Type B					Set screw on key	A	C	G	M	No. of screws per flange
	Bush No.	Max Bore	L	D	E	F	J	*App. weigh t kg	Max Bore	Min Bore	L	D	E	F							
A-40	1108	25	67	-	22	33.5	29	1.4	30	11.00	67	-	22	33.5	M5	2.0	104.0	82	43	23	4
A-45	1108	28	67	-	22	33.5	29	3.0	32	11.00	73	-	25	36.5	M5	2.2	120.0	94	43	23	4
A-50	1210	32	78	79.0	25	39.0	38	3.1	38	16.00	92	79	32	46.0	M5	4.0	133.5	100	43	28	4
A60	1610	42	86	103.0	25	43.0	38	5.2	48	16.00	112	73	38	43.0	M6	5.0	165.0	125	43	36	5
A-70	1610	42	92	76.0	25	50.5	38	7.4	55	19.05	132	82	45	50.5	M6	8.0	197.0	144	10	42	5
A-80	2012	50	111	95.0	32	53.0	47	9.2	65	25.40	149	95	51	53.0	M10	12.0	211.0	167	10	47	6
A-85	2012	50	112	103.0	32	53.5	47	12.5	70	31.75	154	103	53	53.5	M12	14.0	222.0	179	13	48	6
A-90	2517	60	140	110.0	45	59.5	50	15.0	76	31.75	164	110	57	59.5	M12	15.0	235.0	188	13	50	6
A-100	2517	60	148	124.0	45	61.5	50	20.0	85	31.75	178	124	60	61.5	M12	21.0	254.0	216	13	58	6
A-110	2517	60	140	134.0	45	63.5	50	26.5	90	31.75	180	134	65	63.5	M12	28.0	279.0	233	14	50	6
A-120	3020	75	157	152.0	51	70.0	68	35.5	102	38.10	207	152	76	70.0	M12	41.0	314.0	264	14	55	6
A-140	3535	90	204	194.5	89	76.0	89	67.2	120	75.00	204	195	89	76.0	M20	61.0	359.0	313	14	26	8
A-160	4040	100	220	216.0	102	78.0	110	91.0	140	75.00	220	216	102	78.0	M20	86.0	402.0	345	19	16	8
A-180	4545	110	258	266.0	114	94.0	126	146.0	150	75.00	258	266	114	94.0	M20	141.0	470.0	398	19	30	10
A-200	4545	110	278	266.0	114	103.0	126	182.0	150	75.00	276	266	114	103.0	M20	179.0	508.0	429	19	48	12
A-220	5050	125	312	267.0	127	118.0	140	320.0	160	90.00	312	267	127	118.0	M20	312.0	562.0	474	20	56	12
A-250	-	-	-	-	-	-	-	-	190	100.0	360	290	150	125.0	M20	500.0	628.0	532	25	60	12



Tyre Couplings - TC Series

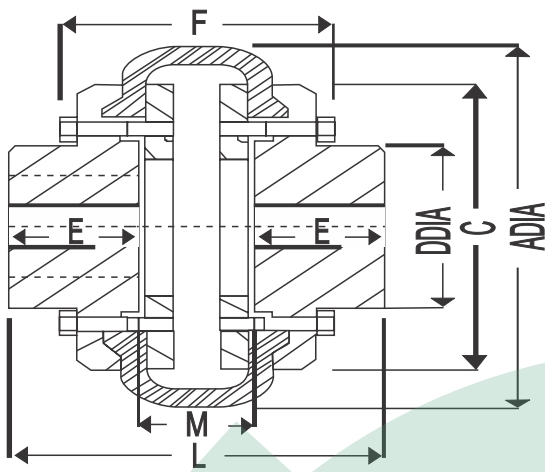

UPTO SIZE TC/017

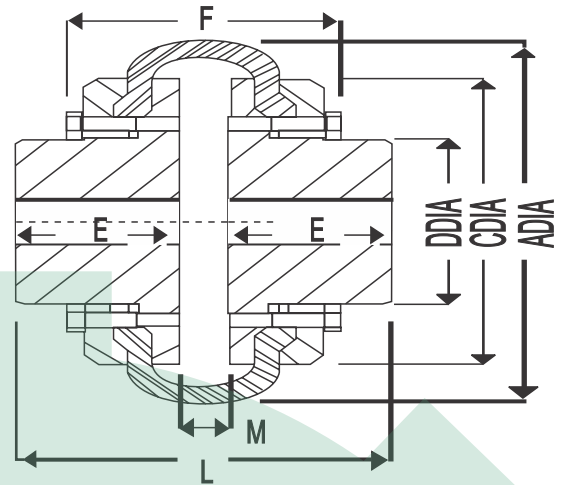

SIZE TC/018 AND LARGER

Size	Max bore mm	Max Speed rpm	Cont. Rating Torque nm	HP/100 rpm	Max Torque Nm	A Dia mm	Appx. Dimension s L inch	D Dia Nm	E Nm	M mm	Torsional stiffness Nm/rad	Interior MR 2 KgM 2	Max Misalignment Radial mm	Axial mm	ANG mm	Weight Kg
TC/001	9	6000	nominal			42	54	27	19	16	60	-	0.1	0.2	3	0.2
TC/002	11	6000	nominal			54	68	38	24	20	150	0.0001	0.1	0.2	3	0.5
TC/003	14	6000	nominal			70	78	43	27	24	220	0.0003	0.1	0.2	3	0.7
TC/004	18	6000	nominal			93	74	30	26	22	415	0.0006	1.5	0.2	3.5	0.9
TC/005	22	5500	6	0.08	18	97	74	35	25	24	520	0.0008	1.5	0.2	4	1.3
TC/006	24	5500	12	0.17	36	105	84	38	32	20	630	0.001	1.5	2.5	4	1.6
TC/007	28	5500	18	0.25	54	105	111	43	40	31	1000	0.001	1.5	2.5	4	1.7
TC/008	32	5500	24	0.34	72	120	95	51	37	21	1455	0.003	1.5	2.5	4	2.7
TC/009	38	5500	36	0.5	108	135	108	58	39	30	1890	0.005	0.2	2.5	4	3.4
TC/0095	42	5500	46	0.65	138	144	120	66	48	24	2400	0.008	0.2	2.5	4	5.2
TC/010	45	4400	54	0.75	162	160	132	71	49	34	2600	0.012	0.2	2.5	4	6.4
TC/011	48	4300	64	0.9	192	164	133	75	51	31	3200	0.016	2.5	2.5	4	7.7
TC/012	45	4200	84	1.18	282	176	147	71	53	41	4000	0.017	2.5	2.5	4	7.4
TC/013	51	3750	132	1.85	396	188	145	80	53	39	4300	0.027	2.5	2.5	4	10
TC/014	62	3200	200	2.8	600	212	155	95	56	43	6200	0.036	2.5	0.3	4	12
TC/015	76	2750	265	3.7	795	240	173	118	62	49	8900	0.084	2.5	0.3	4	19
TC/016	90	2700	355	0.5	1065	270	181	140	68	45	9900	0.148	0.3	3.5	4	27
TC/017	95	2600	565	7.9	1695	280	215	145	76	63	13400	0.189	0.3	3.5	4	32
TC/018	100	2550	720	10.1	2160	310	195	154	90	15	14200	0.305	3.5	0.4	4	42
TC/019	105	2500	940	13.2	2820	316	202	159	96	10	35000	0.358	3.5	0.4	4	48
TC/020	130	2200	1440	20.2	4320	370	225	203	110	6	47600	0.815	0.4	4.5	4	79
TC/021	130	2000	1795	25.2	5365	370	240	203	115	10	66000	0.868	0.4	4.5	4	85
TC/022	150	1700	2870	40.3	8610	412	256	237	118	20	110000	1.49	0.4	0.5	4	115
TC/023	150	1600	4445	62.4	13335	448	280	230	125	30	188000	1.9	4.5	0.6	4	127
TC/024	200	1300	6425	90.2	19275	530	282	315	128	26	200000	4.8	0.5	0.6	4	218
TC/025	165	1250	8215	115.3	24645	546	365	280	147	71	310000	5.2	0.5	0.6	4	224
TC/026 and Larger																



Tyre Couplings - PH Series

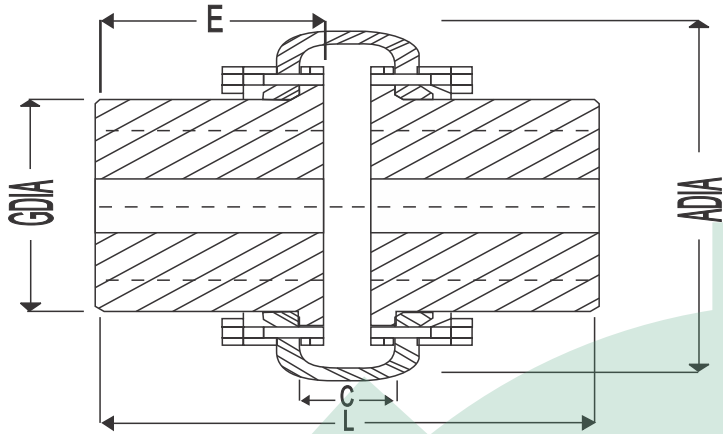

UPTO SIZE 250 H

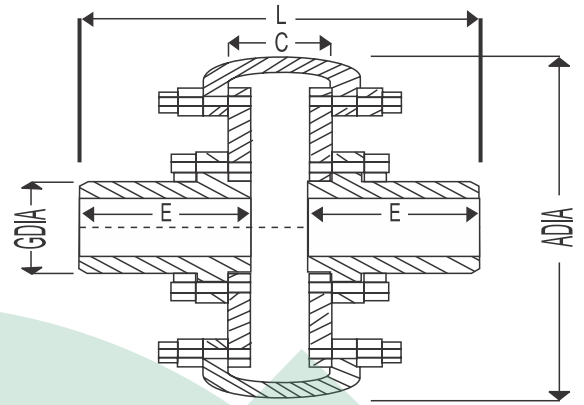

SIZE PH 600 TO PH 1250

Size	Max Bore mm	Max Speed RPM	Cont. Rating Torque Nm	HP/100 RPM	Max Torque Nm	A Dia mm	Appx. Dimensions G inch	E Dia mm	C Nm	L mm	Torsional Stiffness NM/rad	Inertia MR 2 KgM 2	Radial mm	Axial mm	ANG deg	Weight Kg
PH-76	27	6000	18	0.25	54	76	39	30	14	66	225	0.00024	0.1	0.2	4	0.84
PH-86	34	6000	29	0.4	87	86	49	35	14	76	410	0.00055	1.5	0.2	4	1.35
PH-96	36	5500	36	0.5	108	96	51	35	16	76	510	0.00086	1.5	0.2	4	1.5
PH-106	38	5500	45	0.6	135	106	54	35	18	76	618	0.00135	1.5	2.5	4	1.9
PH-116	42	5500	55	0.75	165	116	60	40	22	88	765	0.00230	1.5	2.5	4	2.75
PH-125	48	5500	90	1.25	270	126	68	40	22	88	1275	0.00350	0.2	2.5	4	3.5
PH-140	50	5500	125	1.75	375	140	75	46	26	100	1815	0.0060	0.2	2.5	4	4.75
PH-160	50	5000	165	2.25	495	160	82	50	28	108	2350	0.0112	0.2	2.5	4	6
PH-178	60	4500	220	0.3	660	178	100	60	32	128	3140	0.023	2.5	2.5	4	11
PH-190	65	4000	285	0.4	885	190	105	70	30	146	4170	0.034	2.5	2.5	4	14
PH-218	75	3500	430	0.6	218	124	75	36	160	6380	0.065	2.5	0.3	4	21	21
PH-250	85	3000	610	8.5	1830	250	145	90	40	192	9075	0.123	0.3	3.5	4	32
PH-272S	75	2750	740	10.5	2220	272	125	80	40	173	10800	0.131	0.3	3.5	4	28
PH-272H	100	2750	740	10.5	2220	272	163	96	40	205	10800	0.189	0.3	3.5	4	38
PH-292S	80	2600	1070	0.15	3210	292	130	80	47	175	16200	0.178	3.5	0.4	4	30
PH-292H	105	2600	1070	0.15	3210	292	168	105	47	228	16200	0.243	3.5	0.4	4	44
PH-316S	90	2500	1320	18.5	3960	316	150	90	47	195	18800	0.270	3.5	0.4	4	40
PH-316H	115	2500	1320	18.5	3960	316	190	115	47	245	18800	0.395	3.5	0.4	4	60
PH-342S	90	2250	1870	0.26	5610	342	150	90	53	195	26700	0.360	0.4	4.5	4	45
PH-342H	120	2250	1870	0.26	5610	342	198	120	53	225	26700	0.520	0.4	4.5	4	71
PH-390S	100	2000	2850	0.40	8550	390	165	100	57	218	40700	0.717	0.4	0.5	4	70
PH-390H	140	2000	2850	0.40	8550	390	230	140	57	298	40700	1.10	0.4	0.5	4	115
PH-450S	130	1600	5000	0.70	15000	450	216	120	60	270	71400	1.36	4.5	0.6	4	110
PH-450H	175	1600	5000	0.70	15000	450	286	170	60	360	71400	2.42	4.5	0.6	4	190
PH-520S	150	1480	7150	100	21450	520	250	135	62	294	102000	2.60	0.5	0.6	4	170
PH-520H	220	1480	7150	100	21450	520	324	180	62	384	102000	5.45	5.5	0.6	4	300
PH-600	As Required	1300	12850	180	38550	600	To suit Requirements				184000	On Request	0.6	0.8	4	On Request
PH-672		1100	19230	270	57690	672					275000		6.5	0.8	4	
PH-725		1000	28500	400	85500	725					407000		6.5	0.8	4	
PH-812		850	42740	600	128220	812					612000		0.7	0.8	4	
PH-1000		750	64100	900	192300	1000					918000		0.8	0.8	5	
PH-1100		650	85500	1200	256500	1100					1216000		0.8	0.8	5	
PH-1175		550	107000	1500	321000	1175					1530000		0.8	0.10	6	
PH-1250		500	143000	2000	429000	1250					2040000		0.8	0.12	6	



Resilient Coupling - Z & Y Series

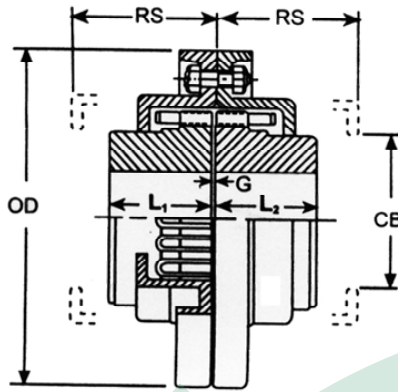

SIZE : RC 1 TO RC 17

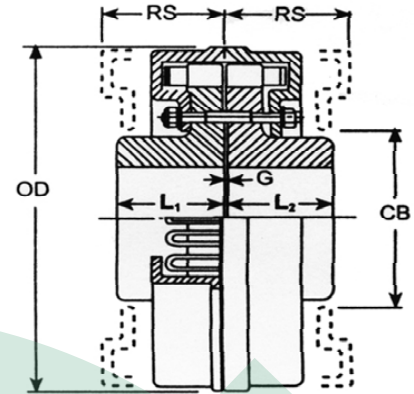

SIZE : RC 20 TO RC 23

FOR HORIZONTAL SHAFTS ONLY

Model		Clear OD mm	Boss Length L1 mm	Boss Length L2 mm	Removal space RS mm	Gap G mm	Cover bore CB mm	Safe speed RPM	Stock Rough bore mm	Max bore mm	Appx. Weight Kgs.
RC 1	0.006	105.00	38	38	52	0.85	44.52	5650	10	29	3
RC 2	0.010	120.50	38	38	52	0.85	58.80	4750	12	38	4
RC 3	0.020	144.50	44.5	44.5	59	0.85	62.00	4450	16	41	5
RC 4	0.030	171.50	51	51	59	0.85	87.45	3400	16	57	9
RC 6	0.045	190.50	51	51	79	0.85	84.25	3200	16	54	11
RC 7	0.065	197.00	57	57	79	0.85	96.25	2950	16	64	15
RC 8	0.095	222.00	63.50	63.50	79	0.85	119.20	2500	25	78	20
RC 9	0.125	254.00	70	70	80	0.85	143.00	2150	25	92	27
RC 10	0.185	276.00	89	89	80	0.85	165.20	1900	25	108	43
RC 11	0.355	295.00	102	102	128	1.60	155.70	1800	38	102	54
RC 13	0.455	324.00	105.50	105.50	147	1.60	187.46	1650	50	123	63
RC 14	0.655	336.50	101.50	101.50	147	1.60	184.28	1550	50	121	72
RC 15	0.905	375.00	114	114	147	1.60	222.38	1350	50	146	104
RC 17	1.255	425.50	127	127	147	1.60	254.00	1200	50	167	149
RC 18	1.755	432.00	140	140	179	3.20	239.5	1200	75	157	175
RC 21	2.405	432.00	140	140	179	3.20	239.5	1200	75	157	180
RC 22	2.755	492.00	152.50	152.50	179	3.20	266.70	1100	85	173	207
RC 23	3.505	492.00	152.50	152.50	179	3.20	266.70	1100	85	173	216



☎ +91 98794 30132

☎ +91 96621 60816



Hydraulic Thruster Brake

Thruster brake is a device to retard the speed and to hold the moving machinery when it is stationary. The braking force to the shoes is applied the spring by means of lever/rod mechanism. The shoes are moved clear off the drum again through lever / arm linkage mechanism by thruster which overcomes spring force.

Application :

Hydraulic Thruster Brake is robust and dependable possessing the stamina needed for the toughest duty conditions imposed by unattended drives un any industry because of its extra-ordinary versatility is has wide application in electrically driven Hoists, Cranes Elevators, Ropeways, Flap Valves Guillotine Machines, Conveyors, Steel Mills, etc.

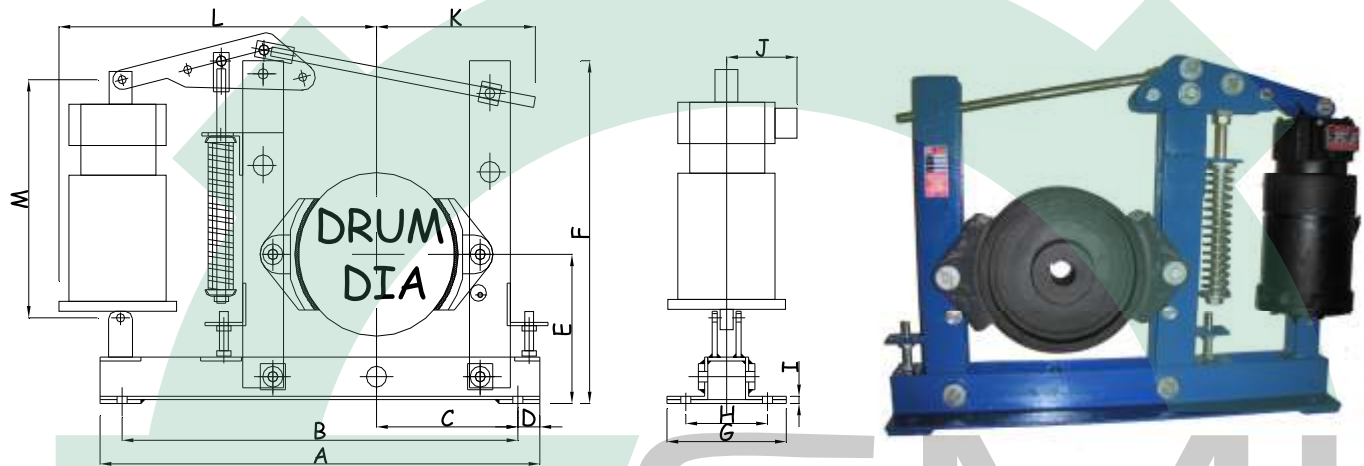

Brake Model	Drum Dia mm	A	B	C	D	E	F	G	H	I	J	K	L	M	Shoe Width	TORQ Kgs.
HTB 100	100	420	265	70	25	129	308	130	112	12	95	150	345	362	60	5
HTB 150	150	470	265	90	25	129	365	130	112	12	95	175	375	362	70	9
HTB 200	200	610	540	115	35	200	470	150	130	12	95	194	405	362	85	20
HTB 250	250	700	630	150	35	234	525	185	135	12	95	244	465	362	105	25
HTB 300	300	775	710	185	35	275	560	205	140	22	95	242	520	362	125	40
HTB 375	375	890	790	225	60	264	625	176	126	20	95	308	608	362	150	48
HTB 400	400	890	790	225	60	264	625	176	126	20	95	320	620	362	150	54

Brake Model	Drum Dia (mm)	Thruster Capacity (Kgs)	Thruster Stroke (mm)	Braking Torque (kgm)
HTB 100	100	18	50	6
HTB 150	150	18	50	9
HTB 200	200	18/34	50	20/34
HTB 250	250	18/34	50	35/42
HTB 300	300	18/34	50	42/62
HTB 375	375	34	50	62
HTB 400	400	34	50	90



Electromagnetic Disk Brake

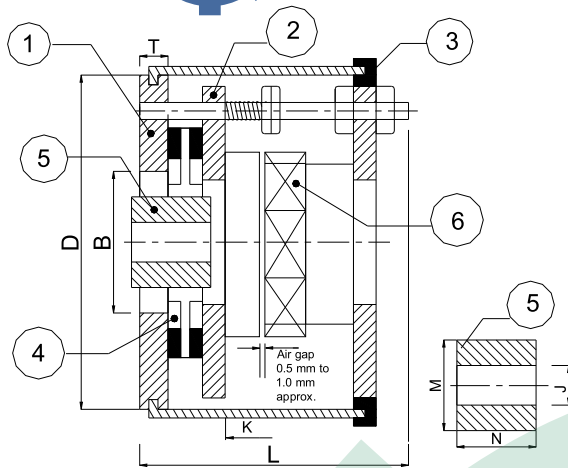

- | | |
|--------------------|-----------|
| 1. MOUNTING PLATE | 6. COIL |
| 2. MAGNET(I) PLATE | 7. STUD |
| 3. COIL(E) PLATE | 8. SPRING |
| 4. LINER PLATE | 9. NUT |
| 5. SQUARE HUB | 10. COVER |

Special Feature:

- ✓ Nylon 'F' Class Coil Bobbin
- ✓ 15.0mm thick. Liner
- ✓ M.S. Plate for liner
- ✓ C.R.N.G.O. Stamping.
- ✓ Insulation coil
- ✓ All Plate C.I (GR25)

Range	Tech Data		Dimensions						
	T. Kg (m)	VA	D.	B.	L.	T.	J. (Dia)	Sq. Hub (M)	N.
EDB 125	0.2	80	128	60	120	12	16	28 x 28	25
EDB 150	1.1	80	153	80	125	18	19	38.1 x 38.1	25
EDB 150 X	2.2	80	153	80	145	18	24	38.1 X 38.1	45
EDB 190	2.5	165	193	110	128	18	28	38.1 X 38.1	28
EDB 190 X	4.5	165	193	110	150	18	28	38.1 X 38.1	45
EDB 235	4.0	205	238	110	140	18	38	50 X 50	28
EDB 235 X	6.0	205	238	110	162	18	38	50 X 50	45
EDB 290	5.5	275	278	115	160	15	38	50 X 50	30
EDB 290 X	11	275	278	115	185	15	42	60 X 60	45
EDB 290 XX	14	275	278	115	205	15	42	60 X 60	60





OUR MAJOR SUPPLY & MAINTENANCE SERVICE IN

- ⊙ Chemical Machinery
- ⊙ Rolling Mill Machinery
- ⊙ Construction Machinery
- ⊙ Mines & Quarry Machinery
- ⊙ Sugar Mill Machinery
- ⊙ Cement Plant Machinery
- ⊙ Oil Mill Machinery
- ⊙ Material Handling



SUPER MECH INDUSTRIES

108/A, Shri Ram Estate, Anup Engg. Compound, B/h. C.M.C. Odhav, Ahmedabad - 382415

☎ 91 98794 30132 | +91 96621 60816 | +91 88495 83013

✉ supremechind@yahoo.com

✉ smigvs@gmail.com

 www.smigearcoupling.com
www.gearcouplingindia.com
www.gearcoupling.net